



Important

This seat cover is tailored to your vehicle only



- Do not fit these seat covers to any other vehicle.
- Please read these instructions carefully and install seat covers exactly as described.
- Incorrect installation may affect SRS Side Seat Airbag operation resulting in injury or death.
- Regularly inspect seat covers for any wear or misalignment which may cause damage to the seat covers.
- Adjust alignment if seat cover twists or moves from its original, centrally aligned position.
- As with all garment type products the threads will give if pulled on too hard. Use just enough force to align and pull the cover without breaking the sewn threads.
- Place these fitting instructions in your glove box after installation for future reference.
- If you have any difficulty during installation, please call The Wetseat office for help.

Care of your Wetseat covers

For light marks and surface dirt a damp cloth, chamois or wet wipes will suffice.

For heavier marks and stains machine wash your Wetseat,

Set to cold wash, gentle cycle using standard washing powder.

Dust off the covers first before putting them into a machine wash.

For salt water, sand or mud also try to hose down your Wetseat, cloth line dry in 1 hour

(Ambient temp 20 degrees Celsius).

Kit Contents

- 1 x Tailored Driver Side Wetseat Cover
- 1 x Tailored Passenger Side Wetseat Cover
- 2 x Tailored Headrest Wetseat Covers



The Wetseat neoprene seat cover is a wet suit for your car seats. These innovative covers are designed for fitting onto all passenger vehicles.

Catering for all seat types, so whether it is a 4x4, ute or the family wagon, The Wetseat is a versatile cover designed for the Australian way of life.

The Wetseat is:

- UV Safe, Wont fade in the sunny Australian conditions
 - Water Resistant, Perfect for the beach, water sports, water crossings, fishing, camping, touring and more!
 - Dust, Dirt, Sand & Mud Resistant, wont let any of these seep through to your seat keeping your seats clean & dry!
 - Superior Comfort & Aesthetically Appealing
 - Abrasion and Chemical Resistant
 - Non Soiling and Non Static, Simple removal of dust and pet hair
- Australia's most trusted neoprene seat cover since 2007.

Contact Us



Inland Australia Pty. Ltd.
Unit 2/10c Childs Road.
Chipping Norton.
NSW. 2170. Australia



+61 2 9724 9499



sales@thewetseat.com



www.thewetseat.com

Our mission is to provide locally developed, OEM quality products and services to our customers, driven by continuous improvement, innovation and research and development.



IMPORTANT: Determine the side of the seat cover by locating the airbag slit opening on the outside bolsters

1. Remove the headrests from the front seats backrests (Fig.1).
2. Release the flap from behind and beneath the front seats if applicable (Fig.2).

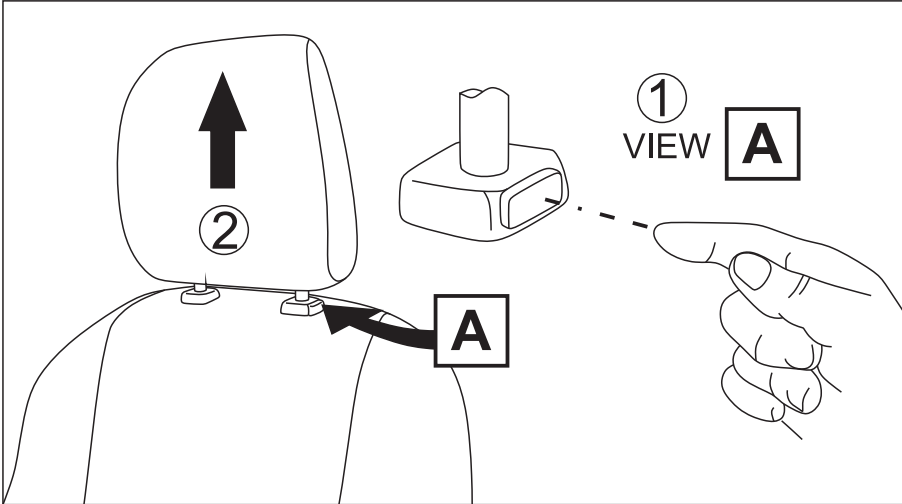

Fig.1

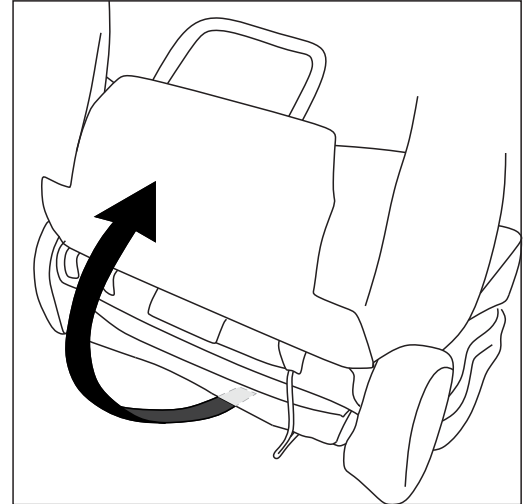

Fig.2

3. Slide backrest cover evenly from both sides over seat backrest (Fig.3).
4. Using your fingers, push backrest cover under headrest guide mechanisms to hold the top part of the backrest cover in place and centrally aligned (Fig.4).

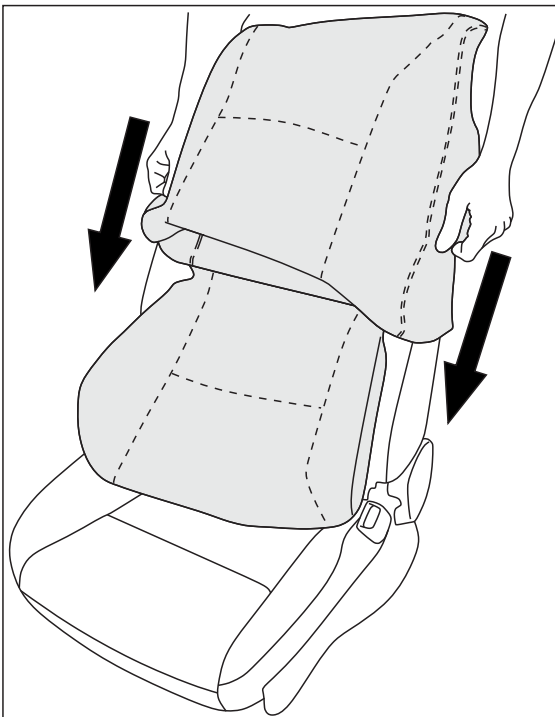

Fig.3

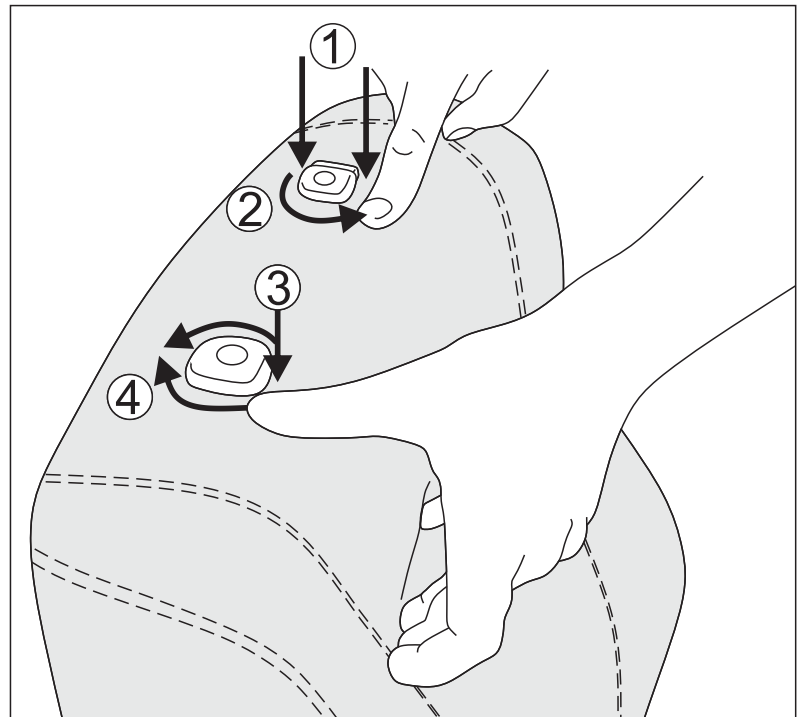

Fig.4

5. Feed the central rod in between the seat backrest and base (Fig.5).

6. Roll base part of the cover over the seat base and align to seat contours (Fig.6)

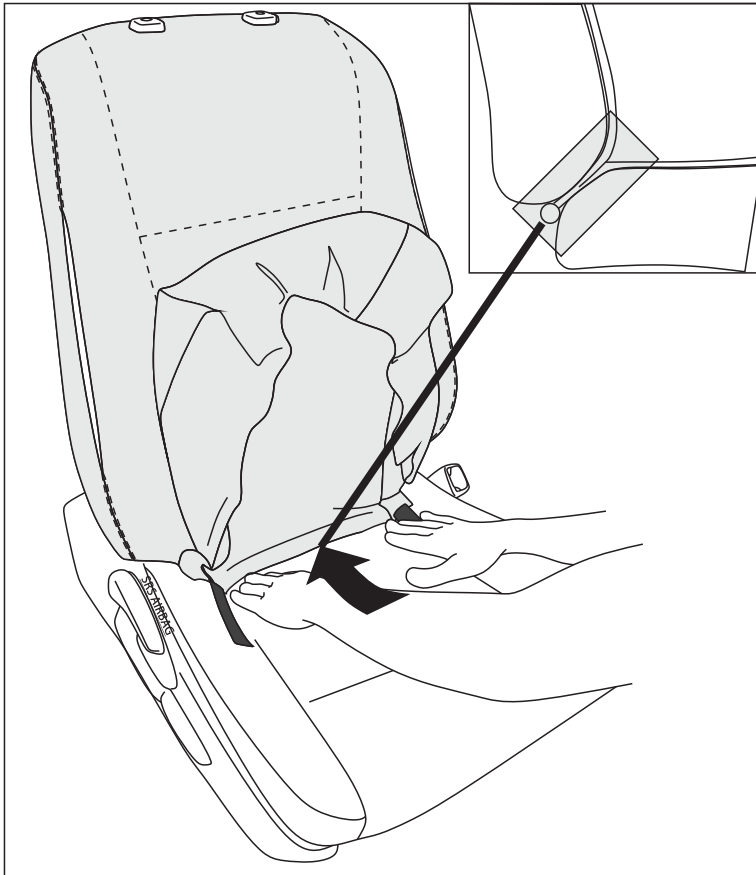

Fig.5

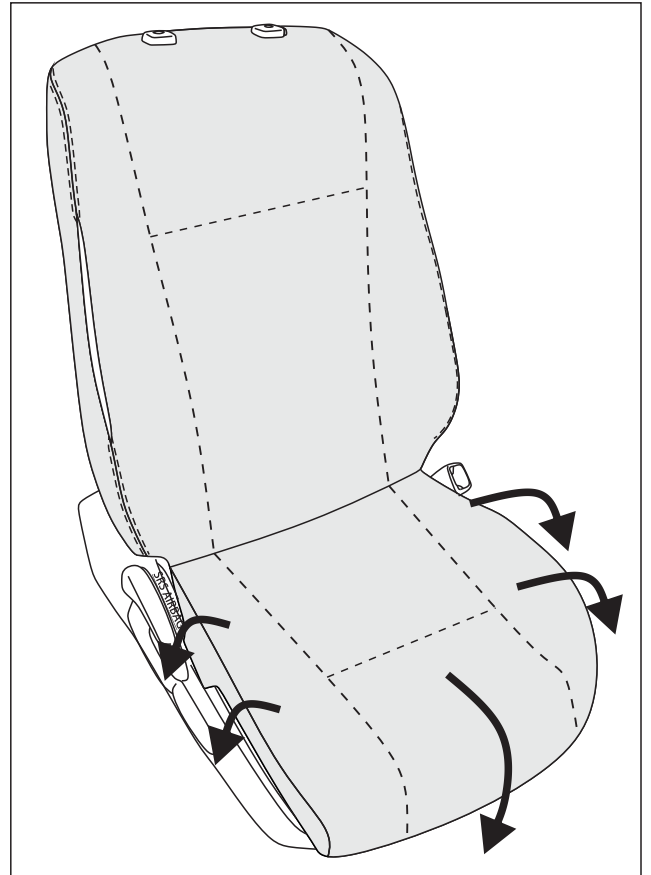

Fig.6

7. From the back of the seat, pull central rod through in between the seat backrest and base to hang out the back.
Be careful not to pull from the soft loop tapes as it may cause the stitching to break (Fig.7).

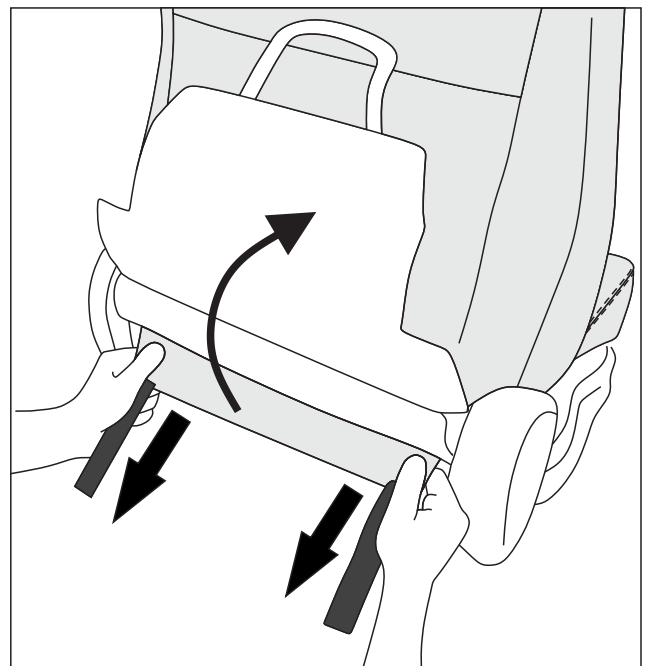

Fig.7

8. From the back of the seat, gently pull the soft loop tapes through and connect to the hard hook tapes behind the backrest cover (Fig.8).

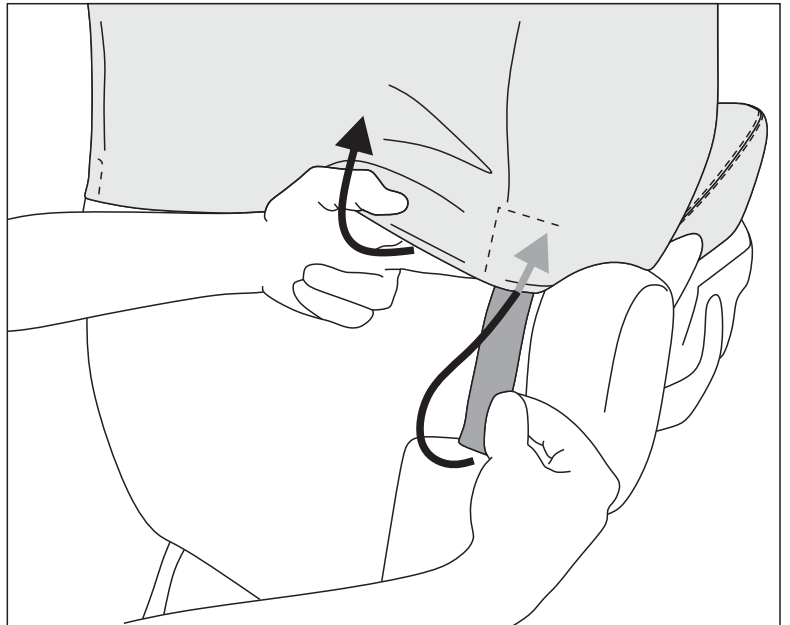

Fig.8

9. Where possible, tuck the sides of the base cover in-between the seat base and plastic trimming surrounding the base (Fig.7).

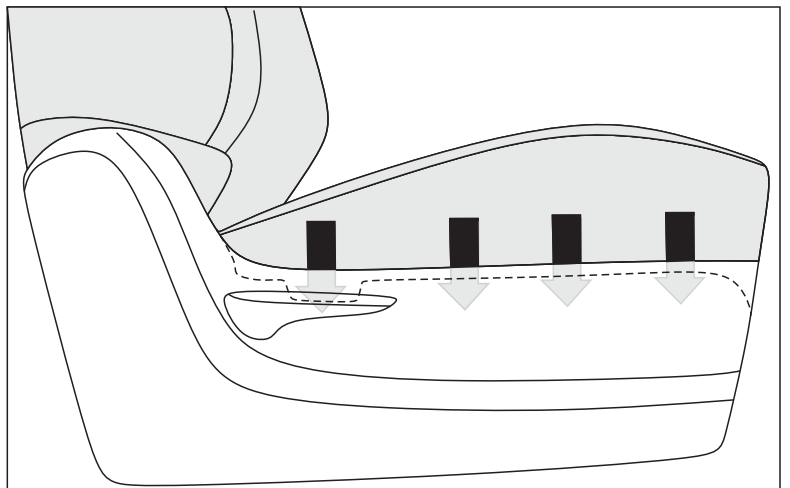

Fig.9

TAILORED HEADREST COVER INSTALLATION

10. Turn the headrest covers inside out and lay upside down on top of the headrest. Proceed to wrap the headrest cover over the headrest by rolling it down evenly. To make sure the headrest cover is being fitted correctly, ensure the seams are aligned before rolling it down. Once fitted, attach the hook and loop tapes underneath (Fig.10).
11. Re-install the headrest to the seat.
12. Repeat steps 1-11 for remaining side cover.

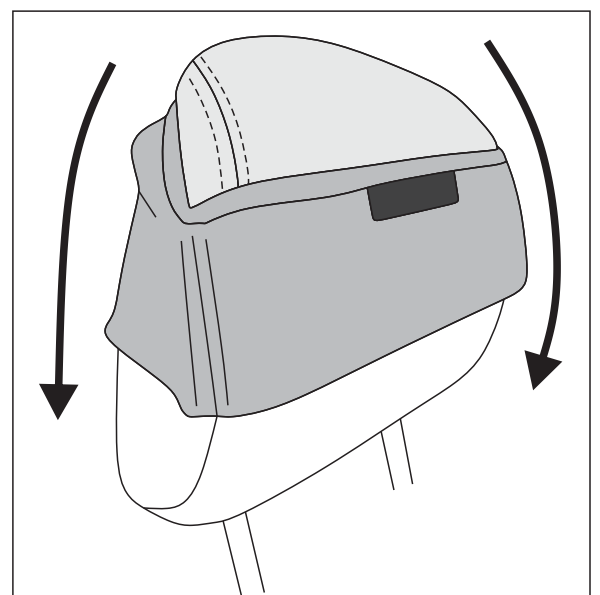

Fig.10